

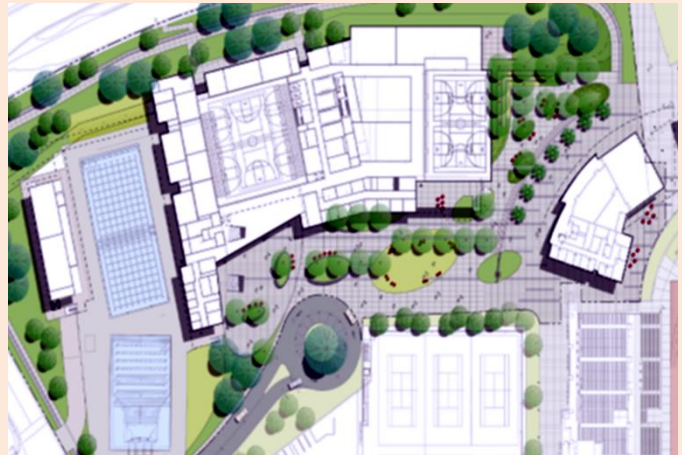

January 29, 2019

Doug Jensen sat in for Mike Gregoryk who was at a conference

1. Cabinet reviewed and discussed the following information items:
 - a. The California Community Colleges launched a cloud-based, system-wide Library Services Platform ([See attached memo](#)). Students will have access to new technology with improved search capabilities, checkouts, overdue book issues, and reserves. Comments from Chisa Uyeki, Reference/Collection Development Librarian: Nearly all community colleges (110 colleges) will be on the same Library platform—the same that the CSUs are currently using. This means that students who learn to search Mt. SAC's library will have an easy time using the library at these other institutions. For staff and librarians it also means enhanced opportunity to collaborate, share processes, and support each other across community colleges.
 - b. Governor Newsom has named Lande Ajose as his Senior Advisor on Higher Education and Lenny Mendonça as Chief Economic and Business Advisor and Director of the state's Office of Business and Economic Development. See the [attached article](#) for more on these appointments.
 - c. Preliminary drawings ([attached](#)) of the layouts and elevation sketches for the Gymnasium/Wellness Center, Aquatics Complex, and Heritage Hall projects have been provided by HMC Architects. See diagram to the right. Mt. SAC received notice ([attached](#)) that the Department of Finance has approved the preliminary plans for the Gym/Wellness project, and funding for plans and working drawings have been encumbered and released for district use.
 - d. Regional community colleges gathered last week at Glendale College for a workshop on best practices for foundations. Presentations were "Developing Capital Campaign Strategies" by Bobbi Abrams, Executive Director, Pasadena City College Foundation, and "Establishing an Alumni Data Base" by Lisa Brooks, Executive Director, Glendale College Foundation.
 - e. Audrey shared her presentation ([attached](#)) at the recent Mt. SAC Outcomes Assessment Summit. Of particular interest to Cabinet were the following:
 - Implementation of AB 19 as Mt. SAC's "Promise + Plus [Pilot] Program." ([See attached presentation slides.](#))
 - Mt. SAC's "Close to Completion" project encourages students to take the last class or two to complete their associate degree, certificate, or transfer preparations. ([See attached presentation slides.](#))
 - f. Three Mt. SAC students have been recognized with honors and awards:
 - Angelica Cruz ([attached](#)) and Marian Huang ([attached](#)) have been selected for the 2019 Phi Theta Kappa All-California Academic Team. Both have been notified that they are semi-finalists for the All-USA Academic Team.
 - Arturo Zaragoza ([attached](#)) has been accepted into the NASA Lucy Student Pipeline Accelerator and Competency Enabler (LSPACE) Program.
 - g. Last year, the Los Angeles/Orange Counties Building and Construction Trades Council sponsored a two-day "Women Build LA/OC" workshop at LA Trade Tech College ([flyer attached](#)). The Trades Council has indicated that they are interested in Mt. SAC hosting the workshop this year. **Ginny will look into this possibility.**
2. Regulations implementing AB 705 Multiple Measure Placement statutes are now in draft form ([attached](#)). Cabinet reviewed and discussed the draft and concluded that Mt. SAC's implementation of AB 705 is compliant.



3. Both CEOs and CFOs have established Student Center Funding Formula Work Groups. The CEOs are exploring SCFF issues ([attached](#)) and the CFO's Advisory Workgroup on Fiscal Affairs has done likewise ([attached](#)) including Transfer-Level English and math Issues ([attached](#)).
4. Last November the Board of Governors had a discussion ([attached](#)) on changes in disaggregation of ethnicity/ancestry data as used in MIS data reporting. The change would be dramatic as shown in the table below from the BOG agenda item.

Broad group	Current no. of subgroups	Proposed no. of subgroups
African American or Black	1	11
American Indian or Alaska Native	1	118
Asian (including Filipino)	10	18
Hispanic or Latino	4	19
Middle Eastern or North African	0	13
Pacific Islander	4	6
White	1	9
Total	21	194

Detailed lists of proposed subgroups are in the [attached](#) 49 page (poorly formatted) document.

5. Strong Workforce Program state funds are distributed as 60% to local college districts and 40% to regional consortia for projects among regional college collaborative. Mt. SAC is part of the LA/OC Regional Consortium, LAOCRC ([link](#)). Last month, the latest round of LAOCRC funding was approved for regional collaborative projects in the Los Angeles Subregion. This distribution of funds for LA approved projects in 2019-20 is [attached](#).
6. Cabinet reviewed and commented on a Makerspace Report to the President ([attached](#)). Cabinet was impressed with the growth in hours that the Makerspace facility is being used. Cabinet also noted the budget scenarios for the project, commenting that the future augmentation would be considered through the ongoing planning and budgeting process. Bill reported that the Community College Chancellor's Office Maker Implementation Grant runs out on May 31, 2019. The college has applied for a National Science Foundation Advancing Informal STEM Learning: Makerspace Grant with first year funding of \$427,276, which if awarded, would not begin until October 1, 2019. Cabinet is supportive, at a minimum, of one-time bridge funding to support the program until a determination on whether or not the NSF grant is forthcoming.
7. Mt. SAC has agreed to collaborate with UC Riverside on an NSF Data Corps Grant, "NSF Harnessing the Data Revolution: Data Science Corps." See the [attached](#) communication from UC Riverside and the [attached](#) summary of the project.
8. The Chancellor's Office has provided guidance ([attached](#)) on tutoring apportionment and basic skills. With the shift statewide away from thousands of basic skills enrollments, the Chancellor's Office has evaluated the language of Education Code 84757 (b) ([link](#)) and determined that claiming apportionment in a supplemental learning course called "supervised tutoring" in order for students to develop the skills necessary for them to be successful is appropriate and permissible. To that end, the Chancellor's Office has determined that colleges may collect apportionment for non-credit supervised tutoring hours in which students are strengthening basic skills even if they are seeking support for such skills in transfer-level courses.
9. Cabinet approved 3 new Requests to Fill and put one on hold ([attached](#)).
10. Items for future agendas (items for the next Cabinet meeting are shown in BOLD):
 - a. Update on Multiple Measures Placement Workgroup (Audrey, Joumana & Team, 3/19)
 - b. Revisions to AP 5200 Student Health Services (Audrey, 4/30)

- c. Review of Holds Placed on Student Registration (**Audrey, Mike, 2/5**)
- d. Student Centered Funding Formula—Continued Follow Up
 - A. Tracking Students in Support Cohorts (Student Support Workgroup (Dale, Antonio, Barbara, 5/7)
 - B. Noncredit Support of SCFF & Multiple Measures (Madelyn, 3/26)
 - C. Implementing SCFF Research Agenda and Data Reporting/Analytics (Barbara, 3/19)
 - D. Auto Award/Near Completion/Selection of Major (Audrey, George, Francisco, Dale, 4/30)
 - E. *EAB Navigate* Schedule Building & Data Analytics (Student Support Workgroup--Dale, 4/30)
 - F. Increasing Financial Aid Awards: *ProVerify* software and Case Management (Audrey, Chau, Dale, 4/30)

11. Quarterly Reports to Cabinet

- a. Emergency Response Plan Quarterly Report (Duetta & Melonee, 3/26)
- b. Room Utilization/Capacity-Load Ratio Project (Mika, Joumana, Kevin Owen, 4/9)
- c. Faculty Position Control Quarterly Report (Joumana & Rosa, 4/16)
- d. Construction Project/Scheduled Maintenance Quarterly Report (Gary, 4/9)
- e. IT Projects Quarterly Report (Dale, 3/12)
- f. Grants Quarterly Update (Adrienne, 3/19)
- g. Dual Enrollment Offerings at Local High Schools Quarterly Report (Joumana, Joel & Francisco, 2/12)
- h. International Student Quarterly Update (Audrey & Darren, 3/26)
- i. Academic Support Alignment Project Quarterly Report (Madelyn, Meghan, 4/23)